

Waddington

Street Rod & Restoration Centre

**HOLDEN—FORD—VALIANT
CATALOGUE**

***SHEETMETAL
AND
REPRODUCTION
PARTS***

**Waddingtons Vic P/L
73 Blakeley Road
Castlemaine
Victoria
3450**

PH 03 54 72 1332

FX 03 54 70 5576

Email: waddingtonsrods@yahoo.com.au

Website: www.waddingtonstreetrods.com.au

HQ-HJ-HX HOLDEN

HQ-HJ MONARO 2 DOOR SKIN:

This is a complete full replacement door skin (same as N.O.S.) including door handle holes, etc. Manufactured from high quality CA3 body steel. Left and Right available.



\$500.00 ea inc.

Part No:

HQ-HJ-HX-HZ-WB SEDAN 2 DOOR SKIN:

This is a complete full replacement door skin (same as N.O.S.) including door handle holes, etc. Manufactured from high quality CA3 body steel. Left and Right available.



\$500.00 inc.

Part No:

HQ-HJ MONARO 2 DOOR FRAME (INNER):

This is the lower inner door frame rust section. It has all factory holes, pressing shapes, etc. Left and Right available.

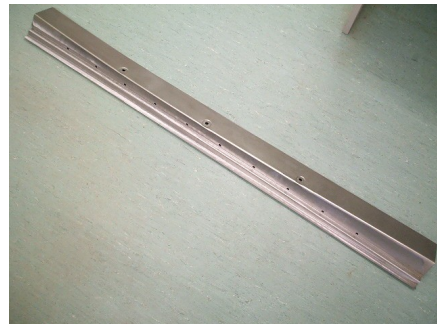

\$120.00 ea inc.

Part No:

HQ-HJ-HX HOLDEN

HQ-HJ MONARO 2 DOOR FRONT LOWER QUARTER PATCH PANEL:

This panel is a rust repair patch panel. It fits between the rear wheel opening and the door opening and is approx. 300mm high. Manufactured from high quality CA3 body steel. Left and Right available.

\$165.00 ea inc.



Part No:

HQ-HJ MONARO 2 DOOR REAR LOWER QUARTER PATCH PANEL:

This panel is a rust repair patch panel. It fits between the rear wheel opening and the rear corner below rear bumper and is approx. 200mm high, Manufactured from high quality CA3 body steel. Left and Right

\$220.00 ea inc.



Part No:

HQ-HJ MONARO 2 DOOR SILLS :

This is a full length sill that is a complete outer sill (rust repair panel). Manufactured from CA3 body steel.

\$220.00 ea inc.

Part No:



HQ-HJ-HX HOLDEN

HQ-HJ-HX SEDAN SILLS:

This is a full length outer sill (rust repair panel). Manufactured from high quality CA3 body steel.

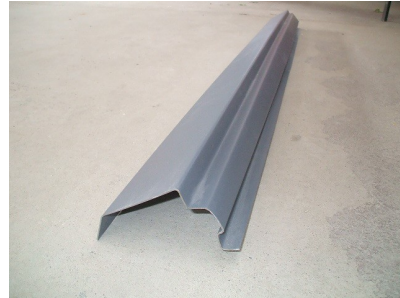

\$220.00 ea inc.

Part No:

HQ-HJ 2 DOOR MONARO RAIN GUTTERS:

The rain gutters are a replacement rust section (they are part of the body and NOT the stainless steel trims).



\$220.00 per set inc.

Part No:

HK-HT-HG HOLDEN

MONARO DOOR SKIN:

This is a complete full door skin (same as N.O.S.) including door handle hole, etc. Manufactured from high quality CA3 body steel. Left and Right available.



\$400.00 ea inc.

Part No:

MONARO AND SEDAN

PARCEL SHELF:

This panel is a complete replacement parcel shelf and has all the factory pressings, holes, etc.



\$650.00 per set inc.

Part No:

MONARO AND SEDAN

UNDER REAR WINDOW PANEL:

This is a replacement panel that is a support under rear window and mounts onto parcel shelf.



\$150.00 ea inc.

Part No:

HK-HT-HG HOLDEN

**MONARO, SEDAN, UTE, PANEL
VAN STATION WAGON
REAR WHEEL ARCHES:**

These panels are a wheel arch rust/flare repair panel. They are to put wheel arches back to original. They are the outer only.



\$220.00 per pair inc.

Part No:

MONARO RAIN GUTTERS:

The rain gutters are a replacement rust section; they are part of the body and NOT the stainless steel trims.



\$350.00 per set inc.

Part No:

**HT-HG-HT SEDAN, MONARO,
STATION WAGON OUTER SILLS:**

This is a full length outer sill (rust repair panel). Manufactured from high quality CA3 body steel. Left and Right available.



\$150.00 ea inc.

Part No:

LC-LJ TORANA

LC-LJ TORANA 2 DOOR, DOOR SKIN:

These are a full replacement door skin (same as N.O.S.). They include the door handle hole and pressing (key lock hole extra). Left and Right available.



\$400.00 ea inc.

Part No:

LC-LJ 2 DOOR LOWER INNER DOOR FRAME:

This is a full length inner lower door frame rust repair panel. It has all factory holes, pressing, etc. Left and Right available.



\$75.00 ea inc.

Part No:

LH-LX-UC TORANA

LH-LX TORANA 2 DOOR, DOOR SKIN:

This is a full replacement door skin (same as N.O.S.). They include the door handle hole, pressings, etc (key lock hole extra). Left and Right available. Made from CA3 body steel.



\$450.00 ea inc.

Part No:

FX-FJ HOLDEN

FX-FJ HOLDEN

TRANSMISSION TUNNEL:

This is a transmission replacement tunnel panel, to enlarge the tunnel to accept large transmissions i.e. V8 conversions.

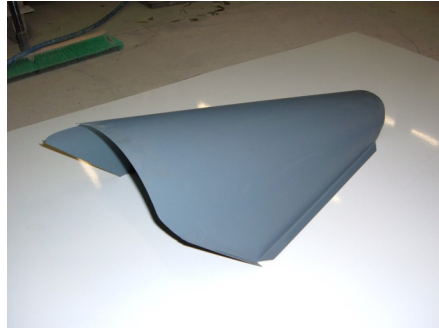

\$100.00 ea inc.

Part No:

FE-FC-FB-EK HOLDEN

TRANSMISSION TUNNEL:

This is a transmission replacement tunnel panel, to enlarge the tunnel to accept large transmissions i.e. V8 conversions.

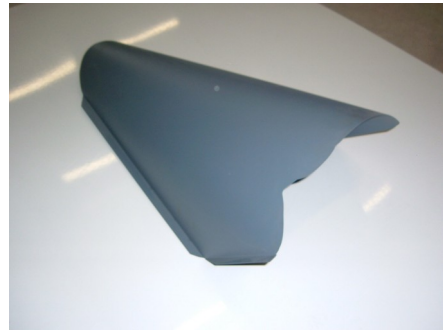

\$100.00 ea inc.

Part No:

FE-FC-FB-BK-EJ-EH HOLDEN

HR TO FE-FC-FB-EK-EJ-EH

OUTRIGGER:

This is a new outrigger to convert and install a "HR" front cross-member into an early Holden. It has to be welded to the "HR" front cross-member (it is NOT a bolt-in unit)

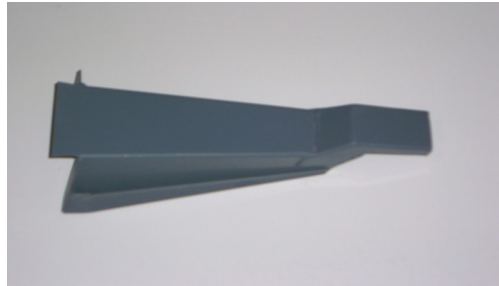

\$95.00 ea inc.

Part No:

XR-XT-XW-XY FORD SEDAN

RAIN GUTTERS:

The rain gutters are a replacement rust section. They are part of the body and NOT the stainless steel trims.



\$350.00 per set inc.

Part No:

SILLS:

This is a full length outer sill (rust repair panel). Manufactured from high quality CA3 body steel. Left and Right available.



\$150.00 ea inc.

Part No:

VALIANT CHARGER

CHARGER BOOT FLOOR:

This is a complete replacement boot floor section which includes Left and Right side wheel well panels. This panel has all the factory pressings, holes, shapes, etc as per original.



\$750.00 ea inc.

Part No:

CHARGER DOOR SKIN

This is a complete full replacement door skin. It has door handle pressed and installed. Manufactured from high quality CA3 body steel. Left and Right available.



\$500.00 ea inc.

Part No:

1955-56-57 CHEV

SEDAN, 2 DOOR OUTER SILLS:

This is a complete outer replacement full length sill. Manufactured from high Quality CA3 body steel.



\$121.00 each inc.

Part No: